

*For the purposes of Planning Consent the following applies to any copy of this drawing made by the Local Authority:
 This copy has been made by and with the authority of the person required to make the plan and drawing open to public inspection pursuant to Section 47 of the Copyright, Designs and Patents Act 1988. Unless that Act provides a relevant exception to copyright, the copy must not be copied without the prior permission of the copyright owner. If any copy is made under the authority only the whole drawing including the copyright holder's name and this notice, is to be copied.*

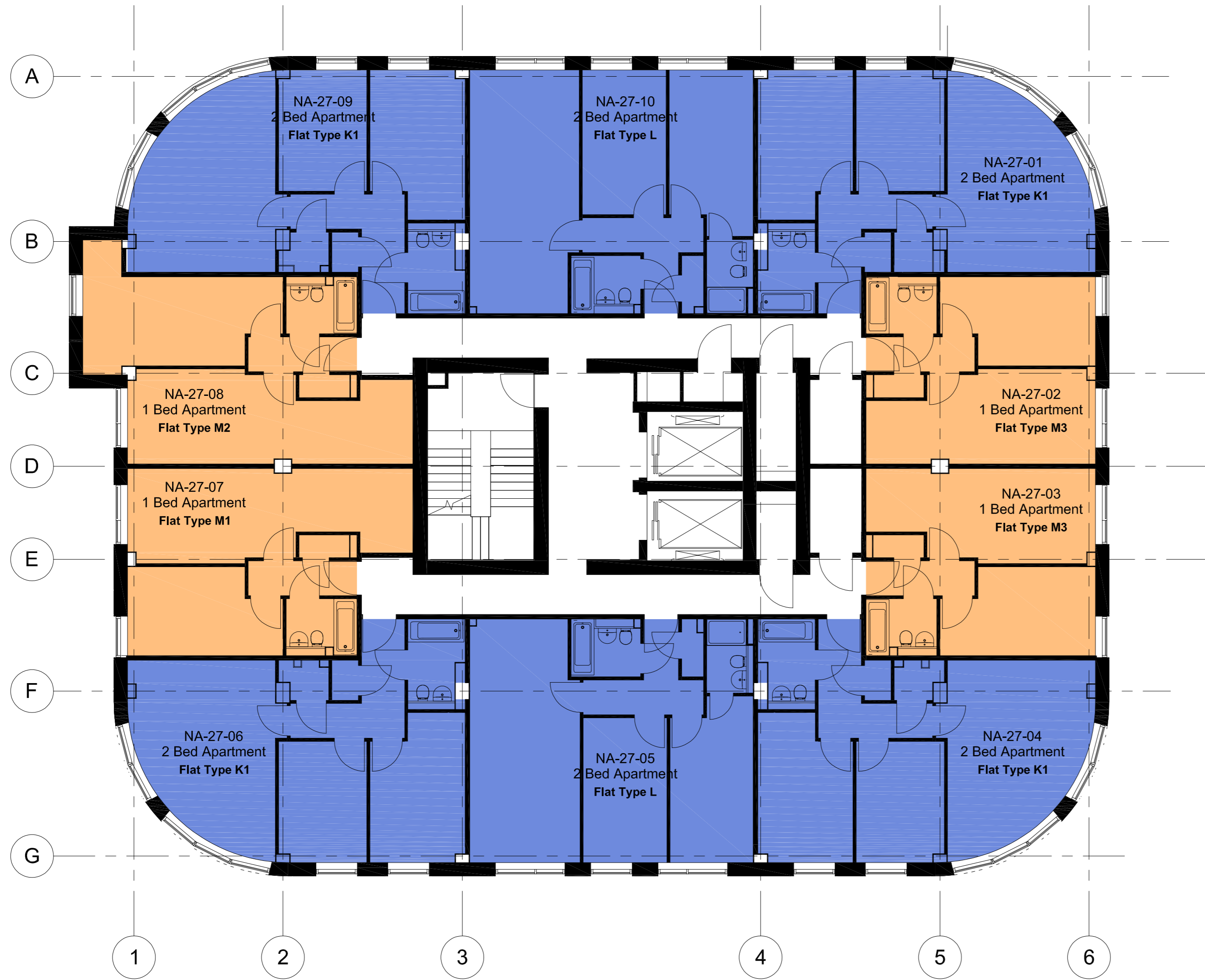

Apartment Type

- 2 Bed Apartment
- 1 Bed Apartment

B2_Level 27
 1 : 100

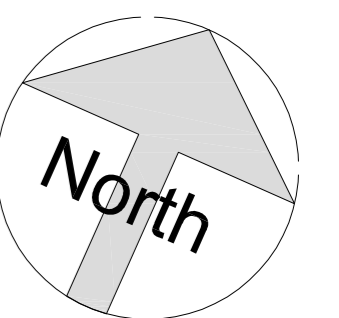

**BEAUMONT
 MORGAN**

Rev P1 : 2019.08.21 : SCJ : PDM : Initial issue.

Issue Purpose: PLANNING APPLICATION

P+HS Architects
 84 Albion Street
 Leeds
 West Yorkshire
 LS1 6AG
 0113 245 4332
 www.pandhs.co.uk

P+HS
 architects

Client	Beumont Morgan	Issued From	Stokesley
Project	2812 - Northhill House Apartments, Fortis Quay	Date	August 2019
Title	Proposed Level 27 FI Plans	Scale	As indicated @ A1
Drawn	SCJ	Auth	PDM
Drawing Number	FQ - PHS - NA - 27 - DR - A - 00 - 207	Status	Revision
Project ID	Orig - Vol - Level - Type - Role - Class - Drg no.	S2	P1

